



mix city

Renens



Contact us:

Contact person:

Fawzi Berrehouma
T: +41 58 445 28 34
M: +41 79 421 12 59

fawzi.berrehouma@steiner.ch
welcome@mixcity-renens.ch
mixcity-renens.ch

Steiner SA
Route de Lully 5
1131 Tolochenaz
steiner.ch



Description

This innovative and multi-purpose project promotes the "productive city". It places the final user at the heart of our concerns.

You are permanently accompanied for the design and development of your floor areas.

Flexible spaces offer numerous possibilities for interior design.

A building designed for its users

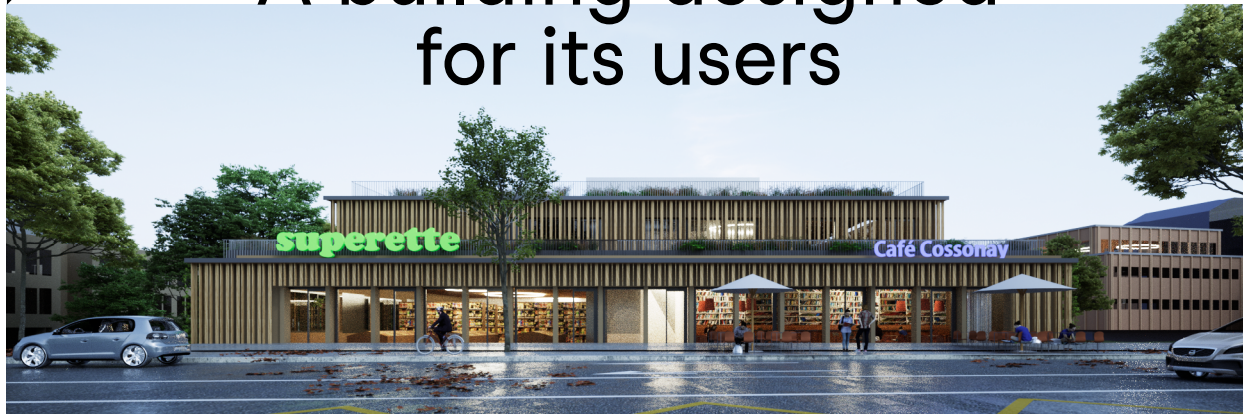

Green construction: MixCity takes up this challenge

The green conception is about reducing the impact of a building on the environment.

For MixCity, environmental efficiency is a priority; elements made of recycled plastic, recycled concrete, wood covering, geothermal probe, photovoltaic panels, eco-domotic and rainwater recovery.

Our Goal : **MINERGIE certification!**

The urban rooftop farm is a true production tool and the first model of its kind in the area with a professional market gardener.

The green roof also helps to reduce heat islands and retain rainwater.





Benefits

- ▶ Mix of users in a synergistic environment
- ▶ First-class accessibility
- ▶ Three levels accessible directly by delivery lorries
- ▶ Three loading docks for all types of vehicles
- ▶ Common areas and shared services to rationalize operating costs
- ▶ Restaurant, terrace and attractive green outdoors for the users' convenience

Spaces

MixCity's ambition is to offer floor areas that can be tailored to all your activities.

The underground and semi-buried floors will be mainly dedicated to storage, logistics and parking areas (-1 / -2 / lower ground floor).

The upper floors (upper ground / intermediate ground) will be dedicated to sales / showroom, catering and production areas.

The Attic, surrounded by a generous balcony, is ideal for user-friendly administrative spaces.

11'700 sqm of adaptable and flexible space





Location

Located in Renens, MixCity is less than 5 km from the centre of Lausanne and 5 minutes away from the A1 motorway. Your future address will also be connected to the Lutry - Lausanne - Bussigny "Bus à Haut Niveau de Service" (BHNS) by the end of 2024.

Come and join the MixCity environment



A fast growing area

MixCity is located in a quality environment in the West of Lausanne, which is experiencing a fast and dynamic transformation. This region will soon be one of the most important axes between Lausanne and Geneva.



Developed by:

The Steiner Group

As a developer and total contractor, we accompany the life cycles of real estate assets from development to completion.

More information on [steiner.ch/en](https://www.steiner.ch/en)

Un développement réalisé par Steiner SA

STEINER